



**Battery System-  
Four Components**

7500-615  
Battery Housing

7500-620  
Battery Pack  
*This part is never  
autoclaved*

7500-630  
Battery Housing

7500-625  
Battery Pack  
*Required to charge  
7500-620*

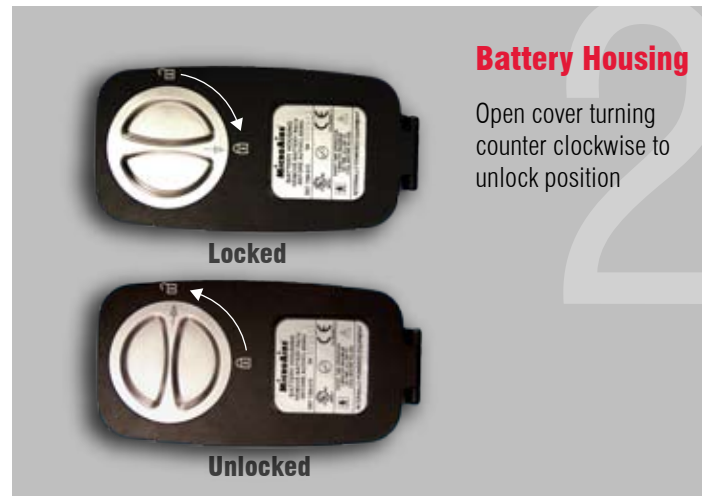

**Battery Housing**

Open cover turning  
counter clockwise to  
unlock position

Locked

Unlocked



**Battery  
Preparations-  
Sterile Field**

Open cover fully



**Transfer Shield-  
Sterile field**

Place Transfer Shield  
on Battery Housing  
opening



**Battery  
Placement-  
Circulator Nurse**

Grasp wire handle of  
Battery Pack, align  
arrows on the Battery  
Pack and insert  
through shield into  
Battery Housing



**Battery  
Placement**

- Push down on battery to be sure it is fully seated in Battery Housing
- Push ring flat



**Remove Shield**

Remove Transfer Shield  
and set outside sterile  
field

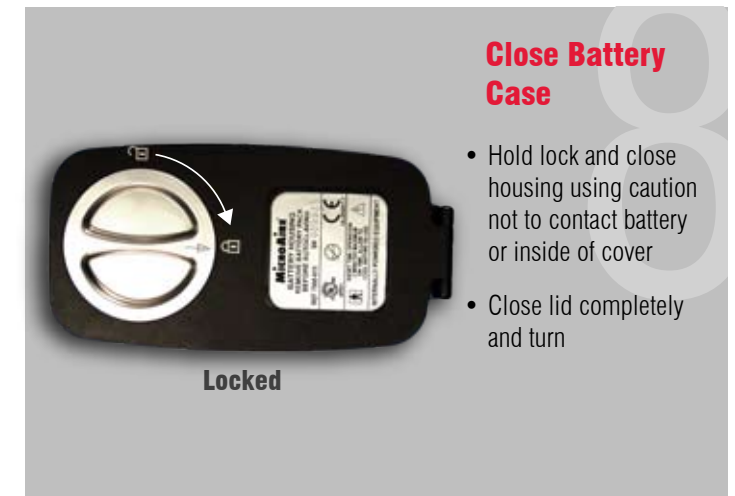

**Close Battery  
Case**

- Hold lock and close housing using caution not to contact battery or inside of cover
- Close lid completely and turn



**Charging Battery**

- Always review operating instructions for MicroAire charger (7500-700)
- Use **Charger Adapter 7500-625 ONLY** to charge Aseptic Battery Pack (7500-620)



**Charging Battery**

- Place Charger Adapter with Battery Pack on Charger
- **DO NOT FORCE** adapter into charging slot



**Sterilization**

Sterilize Battery Housing  
in the open position  
with Transfer Shield and  
instruments

*Note: Have at least  
two complete systems  
for surgery*



**NEVER  
autoclave the  
Aseptic Battery**

Always review MicroAire Instructions for Use for complete details

# Aseptic Battery Kit